

MADE & FOUND

#7

From Fabric 1, cut:
(2) 6¼" x 6¼" squares

From Fabric 2, cut:
(1) 6¼" x 6¼" square

From Fabric 3, cut:
(1) 6¼" x 6¼" square

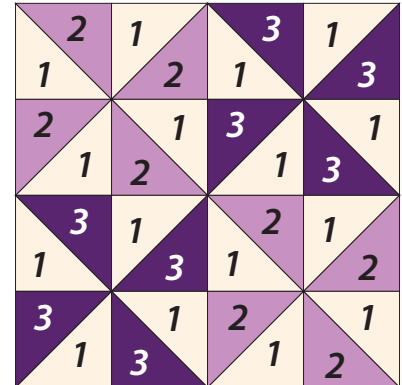

Making the Block:

Finished Size: 9" x 9"

Unfinished Size: 9½" x 9½"

1. Draw two diagonal lines on the wrong side of (2) 6¼" Fabric 1 squares as shown. Place a marked square, right sides together, on (1) 6¼" Fabric 2 square.
2. Sew ¼" away on each side of each of the drawn lines. Cut the squares in half vertically, horizontally and on each diagonally drawn line to make (8) 1-2 HSTs. Press the seams toward the Fabric 2 triangles. Trim each HST, if needed, to measure 2¾" x 2¾".

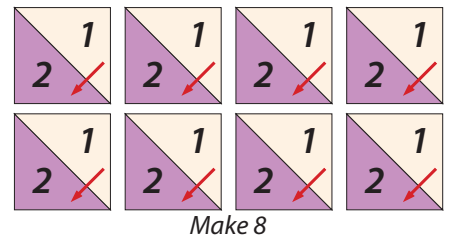
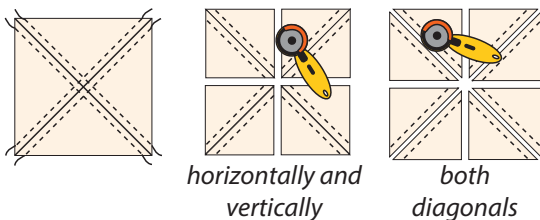
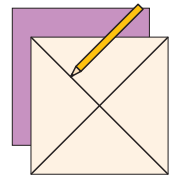

3. Lay out (4) 1-2 HSTs in two rows of two HSTs each, noting the orientation of each HST. Sew the squares together in each row. Press the seams toward the Fabric 2 triangles.
4. Join the rows. Press the seam open to make (1) 5" x 5" 1-2 pinwheel square. Make (2) pinwheel squares.

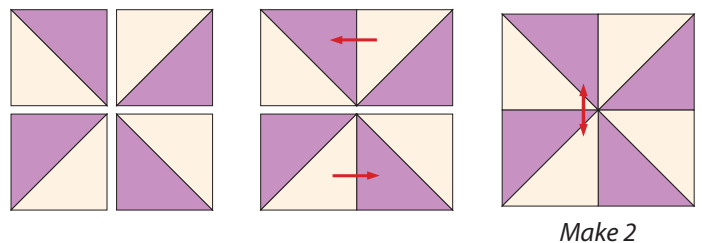

5. Using the second 6¼" Fabric 1 square and (1) 6¼" Fabric 3 square, repeat steps 1 and 2 to make (8) 1-3 HSTs. Press the seams toward the Fabric 3 triangles. Trim each HST, if needed, to measure 2¾" x 2¾".

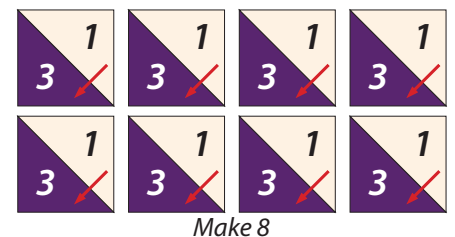

Made & Found - #7

6. Lay out (4) 1-3 HSTs in two rows of two squares each, noting the orientation of each HST. Sew the squares together in each row. Press the seams toward the Fabric 3 triangles.

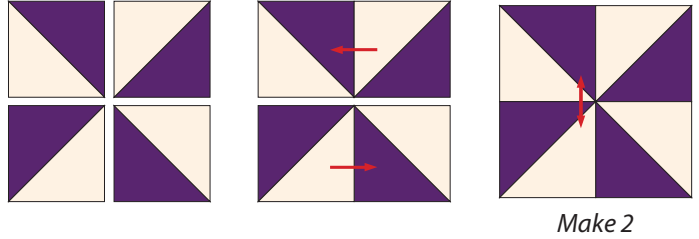

7. Join the rows. Press the seam open to make (1) 5" x 5" 1-3 pinwheel square. Make (2) pinwheel squares.

8. Lay out (2) 1-2 pinwheel squares and (2) 1-3 pinwheel squares in two rows of two squares each as shown. Sew the squares together in each row. Press the seams open.

9. Join the rows. Press the seam open to make (1) 9½" x 9½" block.

